

# Rainbow In My Room

## Amazing Rainbow Projector

A rainbow is a unique and colorful natural phenomenon that occurs when sunlight shines through water vapor in the air. Tiny water droplets in the vapor act like millions of prisms, spreading light out into its visible spectrum of colors: red, orange, yellow, green, blue and violet. It appears across the sky as an arc because incoming rays of sunlight are virtually parallel and because the water droplet prisms are spherical. If the earth did not get in the way of your view, a rainbow would appear as a complete circle. A rainbow is really an optical illusion; it is not really out there in the sky. Its occurrence depends on the viewer's location, the position of the sun, and the presence of water vapor in the air. Now you can enjoy a brilliant rainbow anytime... in your room!

### This package contains:

- Rainbow Projector
- Instructions

### Installing batteries into the Rainbow Projector

Tool required - Small Phillips head screwdriver

Requires four "AAA" alkaline batteries (not included). Install batteries as follows:

1. Using a Phillips head screwdriver, remove the battery compartment cover (see Fig. 1).
2. Insert 4 "AAA" alkaline batteries. Make sure the "+" and "-" ends are inserted correctly, as indicated in the battery compartment.
3. Replace battery compartment cover. Do not over-tighten screws.

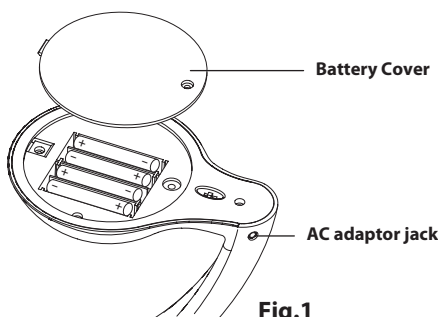

Fig. 1

### Using an optional AC adapter

You can use an AC adapter (not included) instead of batteries. Use 120 volts AC, 60 Hz 7.5 volts DC out, 150 mA. This adapter is available at many home electronics retail stores. Please follow manufacturer's instructions for compatibility and use. The AC adapter jack is located at the base of the Rainbow Projector.

### How to operate

1. On the bottom of the base, select Mode 1 or Mode 2 (see Fig. 2).
  - a. Mode 1 turns rainbow on at once.
  - b. Mode 2 turns rainbow on one color at a time.
2. Gently pass your hand under the arch. A hidden sensor will turn on the rainbow (see Fig. 3).
3. Turn off the rainbow by passing your hand under the arch again.
4. If left on, the rainbow will turn off automatically after 10 minutes.

**Note:** In modes 1 or 2, the sensor is always drawing a small amount of power. To prolong battery life switch to "OFF" during periods of non-use.

### BATTERY SAFETY INFORMATION

- Batteries are small objects. Batteries must be replaced by an adult.
- Follow the polarity (+/-) diagram in the battery compartment.
- Promptly remove dead batteries from the toy.
- Dispose of used batteries properly.
- Remove batteries for prolonged storage.
- Only batteries of same or equivalent type as recommended are to be used.
- DO NOT incinerate used batteries.
- DO NOT dispose of batteries in fire, as batteries may explode or leak.
- DO NOT mix old and new batteries or types of batteries (i.e. alkaline/standard).
- DO NOT use rechargeable batteries.
- DO NOT recharge non-rechargeable batteries.
- DO NOT short-circuit the supply terminals.

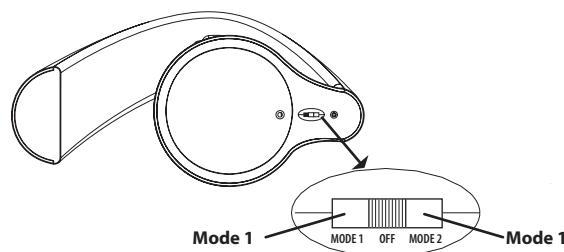

Fig. 2

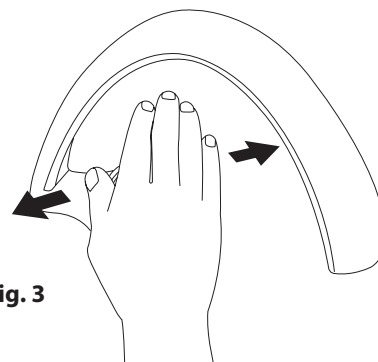

Fig. 3

**KEEP THESE INSTRUCTIONS FOR FUTURE REFERENCE - DO NOT DISCARD**

Problems? Before taking this product back to the store, contact us. Call 1-888-742-2484 or go to [www.unclemilton.com](http://www.unclemilton.com)