

MINI LIGHTSABER™

TECH LAB

Discover the science of light and optics as you build your own mini version of the lightsaber used by Anakin Skywalker.™ Choose from 4 different colored crystals to customize your lightsaber.

Features:

- Real working mini lightsaber
- Four colored crystals for different light effects
- Two lenses for optic experiments
- LED light source

Includes:

- Fun and informative learning guide

Follow assembly instructions **1** through **6** below.

- 5** Insert Blade **OR** Focusing lens **OR** Wide angle lens accessory into Blade shroud. Note: Blade and lenses do not combine.

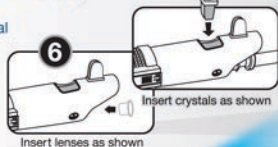
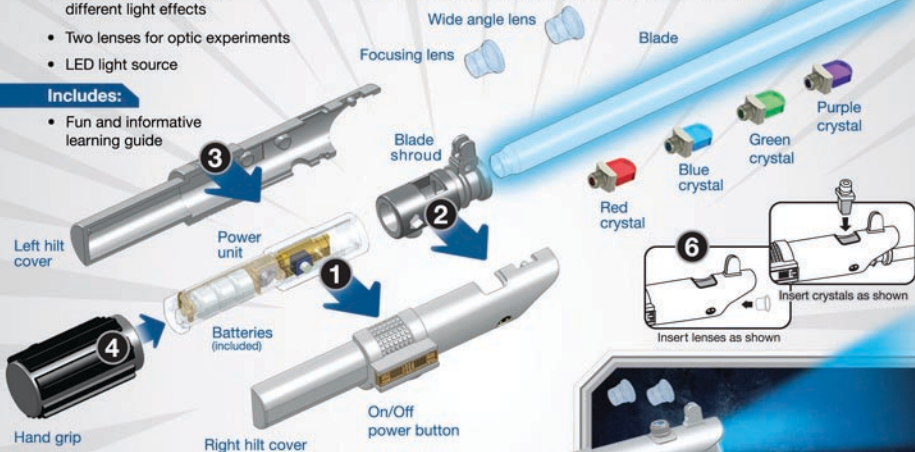

Insert lenses as shown



Change lenses to experiment with optics

OR



Change crystals to experiment with light

x3 Batteries included
Requires 3 1.5V AG5/LR48 batteries

REPLACING BATTERIES
(Follow instructions on bottom panel)



CAUTION: Do not look directly into the light source.
Doing so can cause serious and irreparable eye damage.



starwars.com/fan

© 2010 Lucasfilm Ltd. & TM.
All rights reserved.



0 42499 15071 2

15071-0150-0410 v04