

CAUTION: DO NOT EAT! Web Gel compound may cause allergic reaction in hypersensitive individuals. KEEP AWAY FROM EYES. Adult Supervision Suggested.

STAIN ADVISORY: AVOID WEB GEL COMPOUND CONTACT WITH PAPER, LEATHER, WOOD, STONE, MASONRY, CARPETING, FABRICS, AND TEXTURED SURFACES. COMPOUND MAY STICK TO AND PERMANENTLY STAIN THESE SURFACES. IF CONTACT OCCURS, PROMPTLY REMOVE COMPOUND FROM THESE SURFACES.

Parts included:

- 1 Web Creator Lab Base
- 4 Web Creator Plates
 - Large Web Top Plate
 - Large Web Bottom Plate
 - Multi-Web Top Plate
 - Multi-Web Bottom Plate
- 1 Beaker
- 1 Web Injector
- 1 Web Extractor
- 2 Packs of Red, Sticky Web Gel
- 2 Packs of Blue, Stretchy Web Gel

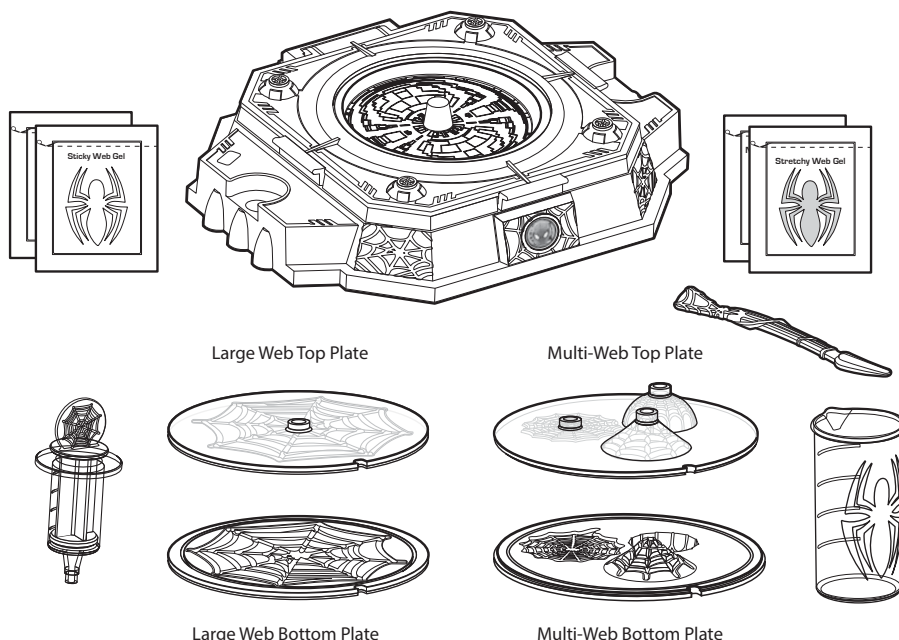

HOW TO CREATE SPIDER WEBS

Now you can create amazing webs just like Spider-Man using the Web Creator Lab. Make 4 different types of webs including a large web, small action web, web ball, and web net. Each of these web types can be made as a sticky web, using the red gel, or a stretchy web, using the blue gel. You can use the web gel over and over again by liquifying it and using it to create fresh, new webs. To create your webs, follow these steps:

1. Select the matching Large Web Plates or Multi-Web Plates. First, place the bottom web plate into the Web Creator Lab base. Be sure to align the web plate correctly using the Plate Key. Add the top plate, aligning with the Plate Key, and close the cover. Press on all three Frame Locks to secure the assembled Web Plates.

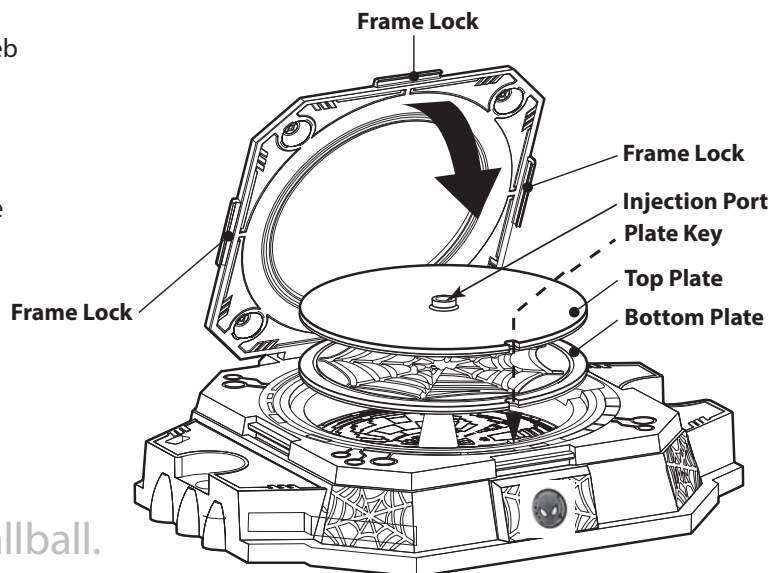

WARNING:

CHOKING HAZARD—Toy contains a small ball.
Not for children under 3 years.

2. Place one packet of red or blue gel into the beaker and fill with hot tap water to the top fill line. Wait until the gel has liquified (about 5 min.).

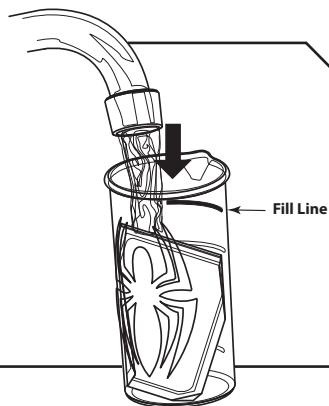

3. While you are waiting for the gel to liquify, insert the Web Injector into the Injection Port at the center of the Web Plate.

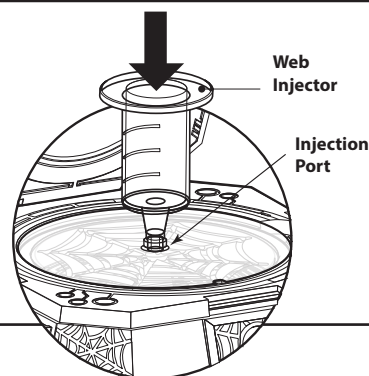

4. Once the gel has liquified, remove the gel packet from the beaker. With assistance from an adult, carefully trim the gel packet with scissors along the dotted line and squeeze the gel into the Web Creator Lab Injector.

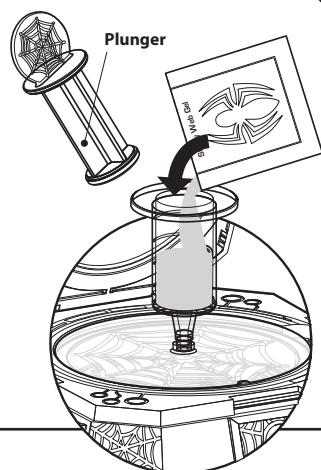

5. Insert the plunger into the Web Injector and gradually press down to inject gel into the Web Plate until the web cavity is full.

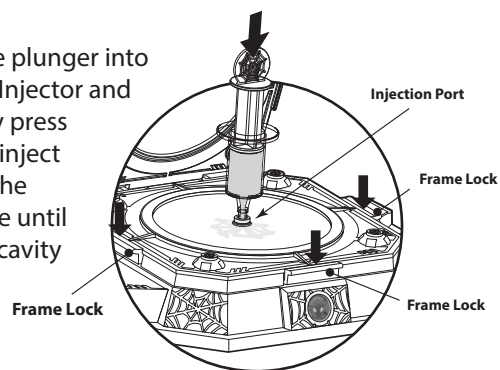

6. Wait 30 minutes for the web to solidify at room temperature. Then, open the cover and slowly remove the Top Plate. Carefully remove the web using the Web Extractor.

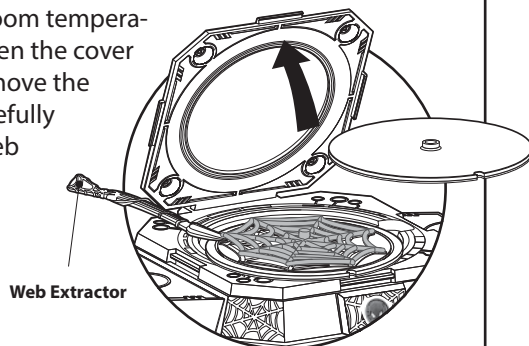

7. Your web is now ready to go. Fling your red, sticky webs and web nets and watch them cling to windows! Stretch and fling your blue webs at villains! Bounce and splat your web balls!

8. To reuse web gel to make new webs, place the used web into the beaker. Place the beaker into a bowl filled with hot water to re-liquify the web gel. Once the gel has completely liquified, repeat steps 4 through 7.

IMPORTANT: ONLY if needed, after reusing web gel five times or more, add ONLY 5 drops of water to the web gel before re-liquifying to recondition the gel to it's original sticky formula.

CLEAN UP FOR HAIR, SKIN AND EYES AND ALL OTHER SURFACES NOT MENTIONED BELOW: Rinse with warm water.

CARPET CLEAN UP:

1. Promptly remove excess compound from carpeting.
2. Moisten area with sponge and hot water.
3. As compound softens, remove remaining compound with light brushing.
4. If stain remains, apply carpet stain remover or rubbing alcohol. Some light colored carpeting may stain permanently.

FABRIC CLEAN UP:

1. Remove excess compound from fabric.
2. Soak fabric in very warm water or hot water.
3. As compound softens, remove remaining compound.
4. Apply fabric stain remover to area.
5. Machine wash and repeat if necessary. Delicate fabrics (such as cotton) and whites may stain permanently.



MANUFACTURED BY UNCLE MILTON INDUSTRIES, INC.
P.O. Box 6281
THOUSAND OAKS, CA 91359 USA
©2013 UMI. All rights reserved.® and TM designate
trademarks of Uncle Milton Industries, Inc. © Marvel
MADE IN CHINA

KEEP THESE INSTRUCTIONS FOR FUTURE REFERENCE — DO NOT DISCARD
Questions? Visit unclemilton.com



18015-0250-0523-V03