

Uncle Milton
STAR WARS
SCIENCE
LIGHTSABER™ CRYSTAL GROWING LAB

ADULT SUPERVISION REQUIRED

1 Heat 400 ml (1 2/3 cups) of water until boiling.

Important: Do not use the lab growing chamber in a microwave or on a stove.

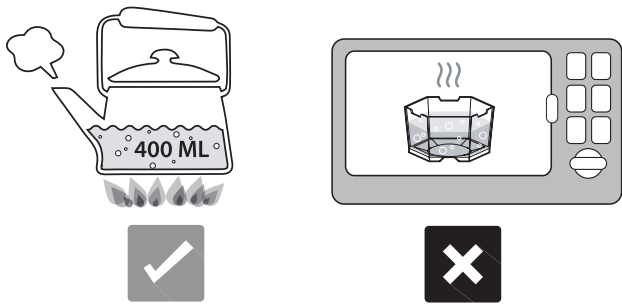

2 Pour 300 ml (1 1/3 cups) of the boiling water into a measuring cup.

Important: Do not pour directly into the lab growing chamber.

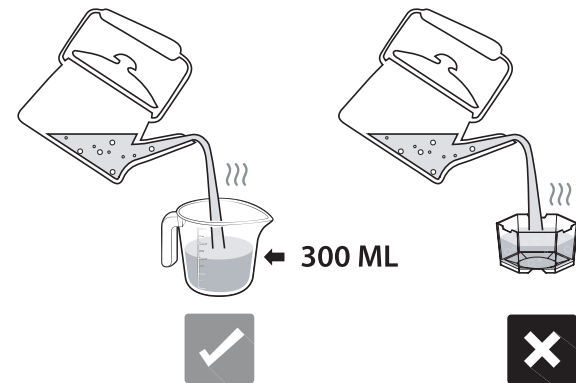

3 Pour the contents of packet A into the measuring cup.

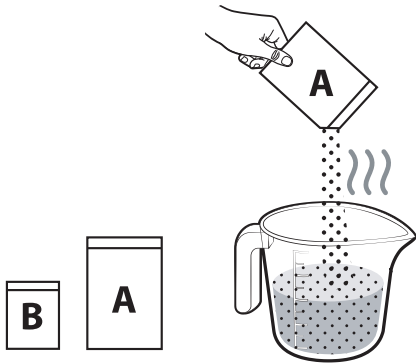

4 Stir until fully dissolved

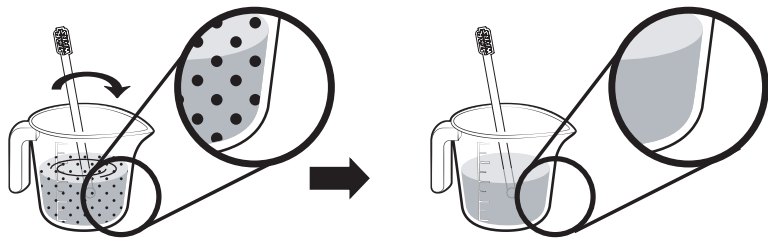

5 Let cool for 10 minutes.



6 Pour into the growing chamber.

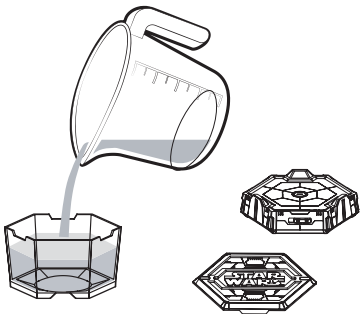

7 Pour the contents of packet B into the chamber and carefully place in a warm area of the house where it will not be moved.

Note: Crystals need temperature above 20° C (68° F) to grow properly.

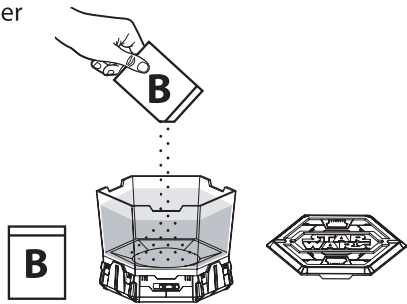

8 While growing, periodically remove crystals above the waterline without disturbing the solution.

Important: Do not stir or put the lid on the container while crystals are growing.

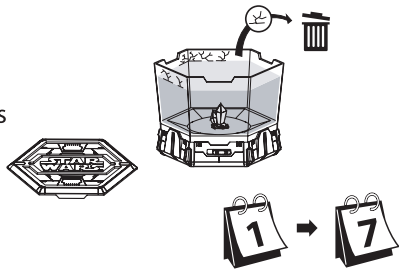

9 After the crystals have grown (approximately 7 days), slowly pour the remaining water out of the chamber.



10 Gently rinse crystals in water.

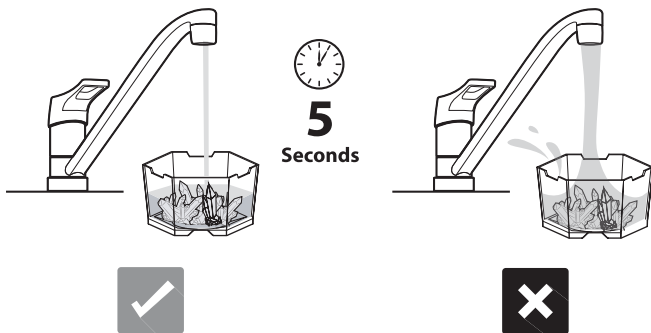

12 Let the crystals dry inside the chamber for 5 days.

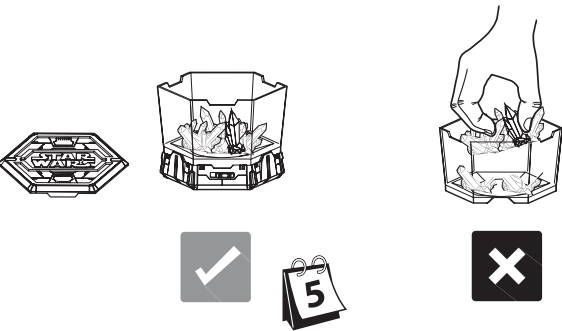

13 Install batteries into the base for lighted display.

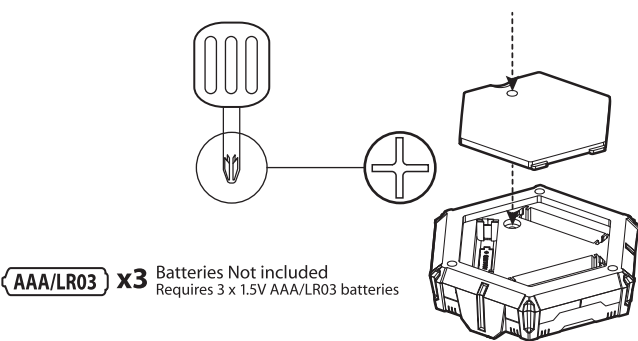

14 Put the cover onto the top of the chamber. Slide the switch to turn on the light.

! Fragile!

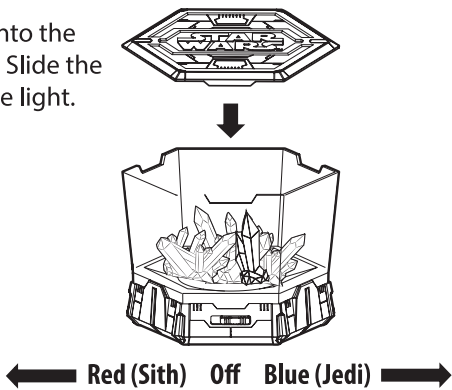

BATTERY SAFETY INFORMATION

- Only adults should install and replace batteries.
- Non-rechargeable batteries are not to be recharged.
- Rechargeable batteries are to be removed from the toy before being charged.
- Rechargeable batteries are only to be charged under adult supervision.
- Different types of batteries or new and used batteries are not to be mixed.
- Batteries are to be inserted with the correct polarity.
- Exhausted batteries are to be removed from the toy.
- The supply terminals are not to be short-circuited.
- Do not mix old and new batteries.
- Do not mix alkaline, standard (carbon-zinc) or rechargeable (nickel-cadmium) batteries.
- Do not dispose of batteries in fire. Battery may explode or leak.
- Batteries should be recycled or disposed of as per state and local guidelines.

Uncle Milton

© 2015 UMI. All rights reserved.
® and ™ designate U.S. trademarks of
Uncle Milton Industries, Inc.
P.O. Box 6281 Thousand Oaks, CA 91359 USA.
Printed in China. Product and colors may vary.

© & ™ Lucasfilm Ltd.
All rights reserved.



WARNING:

CHOKING HAZARD - Small parts.
Not for children under 3 years.
This set contains chemicals that may be harmful if misused. Read
cautions on individual containers carefully. Not to be used by children
except under adult supervision.

Crystal Growth Solution: 140 g, 5oz
Crystal Granules: 0.8 g, 0.03oz



This product and its batteries must be disposed of separately at your local
waste recycling centre. Do not dispose them in your household waste bin.